

⚠ WARNING Before playing this game, read the Xbox 360® Instruction Manual and any peripheral manuals for important safety and health information. Keep all manuals for future reference. For replacement manuals, see www.xbox.com/support or call Xbox Customer Support.

Important Health Warning About Playing Video Games

Photosensitive seizures

A very small percentage of people may experience a seizure when exposed to certain visual images, including flashing lights or patterns that may appear in video games. Even people who have no history of seizures or epilepsy may have an undiagnosed condition that can cause these "photosensitive epileptic seizures" while watching video games.

These seizures may have a variety of symptoms, including lightheadedness, altered vision, eye or face twitching, jerking or shaking of arms or legs, disorientation, confusion, or momentary loss of awareness. Seizures may also cause loss of consciousness or convulsions that can lead to injury from falling down or striking nearby objects.

Immediately stop playing and consult a doctor if you experience any of these symptoms. Parents should watch for or ask their children about the above symptoms—children and teenagers are more likely than adults to experience these seizures. The risk of photosensitive epileptic seizures may be reduced by taking the following precautions: Sit farther from the screen; use a smaller screen; play in a well-lit room; do not play when you are drowsy or fatigued.

If you or any of your relatives have a history of seizures or epilepsy, consult a doctor before playing.

ESRB Game Ratings

The Entertainment Software Rating Board (ESRB) ratings are designed to provide consumers, especially parents, with concise, impartial guidance about the age-appropriateness and content of computer and video games. This information can help consumers make informed purchase decisions about which games they deem suitable for their children and families.

ESRB ratings have two equal parts:

- **Rating Symbols** suggest age appropriateness for the game. These symbols appear on the front of virtually every game box available for retail sale or rental in the United States and Canada.
- **Content Descriptors** indicate elements in a game that may have triggered a particular rating and/or may be of interest or concern. The descriptors appear on the back of the box next to the rating symbol.



For more information, visit www.ESRB.org

CONTENTS

● INTRODUCTION	5
● COMPLETE CONTROLS	5
CHARACTER CONTROL	5
TARGETS AND DEFAULT ACTIONS	5
RADIAL MENU	5
BATTLE MENU	5
SPECIAL ABILITIES	6
● MAIN MENU	6
LOG IN	6
DOWNLOADABLE CONTENT	6
● CHARACTER GENERATION	6
GENDER	6
RACE	6
HUMAN	6
ELF	7
DWARF	7
RACIAL BENEFITS	7
CLASS	7
WARRIOR	7
MAGE	7
ROGUE	7
CLASS BENEFITS	8
BACKGROUND	8
HUMAN NOBLE	8
MAGI	8
CITY ELF	8
DALISH ELF	8
DWARF COMMONER	8
DWARF NOBLE	9
BACKGROUND BENEFIT	9
CUSTOMIZATION	9
NAME	9
APPEARANCE	9
PORTRAIT	9
VOICE	9
ADVANCED	9
DIFFICULTY	10
CASUAL	10
NORMAL	10
HARD	10
NIGHTMARE	10

● CHARACTER PROGRESSION	10
ATTRIBUTES	10
STRENGTH	10
DEXTERITY	11
WILLPOWER	11
MAGIC	11
CUNNING	11
CONSTITUTION	11
QUICK-PLAY PICKS	11
SKILLS	11
COERCION	12
STEALING	12
TRAP-MAKING	12
SURVIVAL	12
HERBALISM	12
POISON-MAKING	12
COMBAT TRAINING	12
COMBAT TACTICS	12
TALENTS/SPELLS	13
ACTIVATED ABILITIES	13
PASSIVE ABILITIES	13
SUSTAINED ABILITIES	13
EXPERIENCE AND LEVELS	13
PARTY MEMBERS	14
APPROVAL	14
SPECIALIZATIONS	14
WARRIOR	14
BERSERKER	14
CHAMPION	14
TEMPLAR	14
REAVER	14
MAGE	15
ARCANE WARRIOR	15
BLOOD MAGE	15
SHAPESHIFTER	15
SPIRIT HEALER	15
ROGUE	15
ASSASSIN	15
BARD	15
DUELIST	15
RANGER	15
SPECIALIZATION BONUSES	16
QUESTS	16

CONVERSATION	16
PERSUASION	16
INTIMIDATION	16
OTHER ATTRIBUTE CHECKS	16
JOB BOARDS	17
JOURNAL	17
CODEX	17
CONVERSATION HISTORY	17
DOWNLOADABLE CONTENT	17
MAPS	17
● COMBAT	20
HEALTH	21
STAMINA/MANA	21
FATIGUE	21
ATTACK	21
FLANKING	21
RANGE	21
COVER	21
DEFENSE	22
MISSILE DEFENSE	22
DAMAGE	22
ARMOR AND ARMOR PENETRATION	22
DAMAGE TYPES AND COLORS	22
ELEMENTAL RESISTANCES	23
CRITICAL HITS	23
BACKSTABS	23
STRENGTH MODIFIERS	23
INJURIES	23
ENEMY RANKS	23
WEAPON STYLES	23
SINGLE WEAPON	24
WEAPON AND SHIELD	24
DUAL WEAPONS	24
TWO-HANDED WEAPON	24
MAGE'S STAFF	24
BOW	24
MAGIC-SPECIFIC RULES	25
SPELLPOWER	25
SPELL INTERRUPTION	25
SPELL COMBINATIONS	25
FRIENDLY FIRE	25

STATUS EFFECTS	25
PHYSICAL RESISTANCE	25
MENTAL RESISTANCE	25
STUN/PARALYSIS/FEAR/IMMOBILITY/PETRIFICATION	26
DISORIENTATION	26
SLEEP	26
CHARM	26
COMBAT TACTICS	26
BEHAVIOR	27
BASIC TACTICS	27
CUSTOM TACTICS	27
Ⓢ ITEMS	28
INVENTORY	29
CONTAINERS/LOOT	29
MATERIALS	29
ITEM SETS	29
ITEM POWERS	29
RUNES	29
GIFTS	30
CURRENCY	30
STORES	30
CRAFTING	30
QUICK-USE ITEMS	30
HEALTH POULTICES	30
INJURY KITS	30
LYRIUM POTIONS	30
ELEMENTAL SALVES	31
WEAPON COATINGS	31
POISONS	31
GRENADES	31
TRAPS	31
LURES	31
MABARI CRUNCH	31
OTHER QUICK-USE ITEMS	31
Ⓢ XBOX LIVE	31
CONNECTING	32
FAMILY SETTINGS	32
Ⓢ CREDITS	32
Ⓢ LIMITED 90-DAY WARRANTY	37

INTRODUCTION

Dragon Age: Origins is a modern re-imagining of an epic party-based fantasy role-playing game, dense with story and tactical combat. Because *Dragon Age: Origins* doesn't shy from that complex heritage, there's a lot to know.

Since many of the game's systems are deeply interrelated, keep a finger on the table of contents; you'll need it to find your way around when an explanation of one feature refers to another. One last note: while there was no way to list the hundreds of spells and talents in here, you'll find full explanations of them in the game.

COMPLETE CONTROLS

Once you complete the character generation sequence described on p. 6, you will find yourself in control of your character, and possibly in control of a second character as well, depending on the background story.

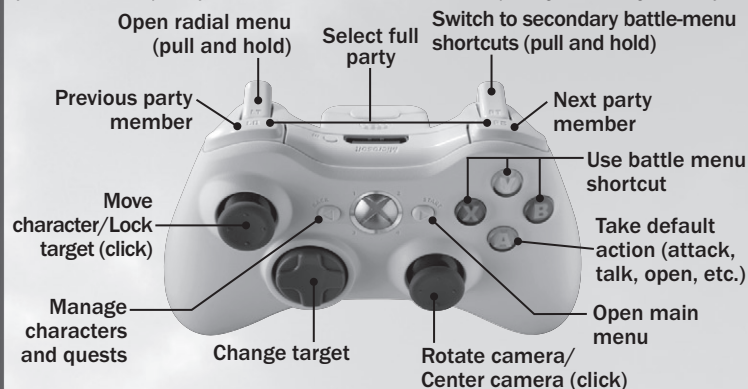

CHARACTER CONTROL

The **○** and **Ⓢ** control character movement and camera movement, respectively. If you have multiple active party members, you can switch among them by pressing **△** or **□**, or you can select your whole party at once by pressing **△** and **□** simultaneously. In the Advanced segment of the radial menu, you can also order your party members to hold their position instead of following you.

TARGETS AND DEFAULT ACTIONS

You can interact with any character, creature, or object that displays a name and an icon when you target it (either by walking up to it or by cycling through all possible targets by pressing **○**). To take a default action—say, to speak to a friendly character, open a chest or a door, or attack an enemy—select the target and then press **A**.

RADIAL MENU

More advanced controls, like using a special ability or consuming a health poultice, are controlled through the radial menu, which appears when you pull and hold **○**. The radial menu is organized into related categories of abilities, items, and party commands, almost any of which can be assigned to a shortcut on the battle menu.

BATTLE MENU

The battle menu is the six icons (in two layers) displayed in the bottom-right corner of the screen. To activate the primary shortcuts, press **X**, **Y**, or **B**. To activate the second layer of shortcuts, pull and hold **○** and then press **X**, **Y**, or **B**.

SPECIAL ABILITIES

When you select an ability that affects a whole area rather than a single target—either in a cone shape or a circle shape—the game pauses automatically so that you can select a target area. Depending on the size of the area affected, the camera may also zoom out to a tactical view so that you can position the target effectively. The game also pauses when you select an ability that affects your party members instead of your enemies. In that case, you choose your target from among the characters' portraits on the left side of the screen.

MAIN MENU

The main menu is mostly self-explanatory. To begin playing, select **NEW GAME**; to resume your game in the future, select **LOAD GAME**; or to load your most recent saved game, select **RESUME**.

These are the options that might not be as obvious:

LOG IN

This lets you create a BioWare/EA account (or log in to an existing account) so that you can track your achievements and character profile at <http://social.bioware.com>.

DOWNLOADABLE CONTENT

This displays new content made available after the release of *Dragon Age: Origins*—both free and for purchase—and also lets you manage the content you've already downloaded.

CHARACTER GENERATION

Before you begin playing *Dragon Age: Origins*, take a few minutes to build a unique character and learn the rudiments of the game's rules system. When you select **NEW GAME** from the main menu, a short introductory movie plays. That brings you to the following options on the character generation screen.

GENDER



Your character's gender does not affect stats or abilities, but does alter some dialogue and plots—as well as facial options and body shape, of course.

RACE

Your character's race determines physical size and natural capabilities as well as how they fit into the world of *Dragon Age*, where interracial tensions are a fact of life.

Human

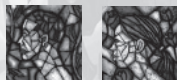

Humans are a well-rounded people, which has made them the most numerous inhabitants of Thedas, and thus the most dominant.

Elf



Thousands of years ago, elves ruled the surface of Thedas, but today they live in mankind's shadow, whether as an oppressed underclass confined to urban slums or, in the case of the Dalish tribes, forced to wander the ancient forests forever.

Dwarf



The dwarves are a race in decline, as each new day of a centuries-old war against the darkspawn consumes both dwarven lives and the scant remaining territory of their underground kingdom. Dwarves have an innate resistance to magic, preventing them from becoming mages.

RACIAL BENEFITS

	HUMANS	ELVES	DWARVES
Starting bonuses	+1 strength	+2 willpower	+1 strength
	+1 dexterity	+2 magic	+1 dexterity
	+1 magic		+2 constitution
	+1 cunning		+10% chance to resist hostile magic

CLASS

Class determines which abilities your character can learn during the course of the game. It has a profound impact on the way a character performs in battle. For mages, class also determines your background story.

Although there is some overlap between the classes, you can never make a character from one class play like a character from another—for example, warriors and rogues can never learn to cast spells, and a mage can never learn advanced weapon talents. Rogues can learn more skills than other classes, but cannot become proficient with two-handed weapons or shields.

Warrior



Warriors are front-line fighters, the backbone of any party under assault. They rely on melee and ranged weapons, supplemented by powerful special abilities that draw from deep reserves of stamina.

Mage



Mages are the only characters who can cast spells, which they use both for offense and to support themselves and their party. Although mages may wield physical weapons, they do so without any particular skill; instead, they prefer to carry staves that fire magic projectiles. Mages cannot stand toe-to-toe with enemies as well as other classes can, but they can deal immense amounts of damage and heal their allies when protected by the party.

Rogue



Rogues are crafty combatants who succeed in battle by combining speed, subterfuge, and a wide range of abilities to bring their opponents down in unexpected ways, sometimes before the enemy even perceives danger. Rogues can pick locks with great skill, incapacitate enemies with ease, or sneak up on targets to deliver a devious and crippling backstab.

CLASS BENEFITS

	WARRIORS	MAGES	ROGUES
Starting health	100	85	90
Starting stamina/mana	100	115	90
Starting attribute bonuses	+4 strength	+5 magic	+4 dexterity
	+3 dexterity	+4 willpower	+2 willpower
	+3 constitution	+1 cunning	+4 cunning
Starting skill	Combat Training	Herbalism	Poison-Making
Starting talent/spell	Shield Bash, Pinning Shot, or Dual-Weapon Sweep	Arcane Bolt	Dirty Fighting
Levels to gain one skill	3	3	2
Health per level	6	4	5
Stamina/mana per level	5	6	4
Base attack score	60	50	55
Base defense score	45	40	50

BACKGROUND

Your character's background—the "Origins" component of the game—determines which of six distinct opening acts you play through, and continues to affect your experience throughout the game. Although there are six different backgrounds, they are each tied to certain combinations of race and class; by the time you select your race and class, you only have one or two choices of background.

Human Noble



Human warriors and rogues always belong to the noble house Cousland, one of the most powerful families in Ferelden. But even a life of privilege can crumble in the face of betrayal...

Magi



Human or elven mages, from the Amell or Surana families, respectively, find that a long childhood of tutelage in the magic arts is finally at a close: it is time to undertake the Harrowing, the long-secret ritual by which an apprentice spellcaster either becomes a full mage ... or disappears forever.

City Elf



Elven warriors and rogues can opt to become a member of the Tabris family, hardscrabble city elves confined to the poorest quarter of the city of Denerim, where an arranged marriage offers hope of distraction—if only for a day—from a life of discrimination and abuse. But when a local lord claims his "right" with the bride, racial tensions provide fuel for a massacre.

Dalish Elf



Elven warriors and rogues may alternately choose a proud but trying life among the Mahariel clan of the Dalish elves, preferring to wander the ancient forests in perpetual isolation over letting humankind corrupt the last of true elven culture. But a chance encounter with a relic of your people's past threatens to change those plans.

Dwarf Commoner



Dwarven warriors and rogues may begin among the Brosca family of the "casteless," the lowest rung of dwarven society, where subservience to a local crime lord has always seemed like the surest way to remain alive, at least for one more day.

Dwarf Noble



Dwarven warriors and rogues may alternately choose a life born to the royal family of Orzammar, House Aeducan, where the natural accompaniment to political power is cutthroat infighting between relatives.

BACKGROUND BENEFIT

	HUMAN NOBLE	MAGI	CITY ELF
Starting skill	Combat Training	Combat Tactics	Coercion

	DALISH ELF	DWARF COMMONER	DWARF NOBLE
Starting skill	Survival	Stealing	Combat Training

CUSTOMIZATION

When you create a new character, you can customize him or her in a variety of ways during the character-generation process. Other party members you acquire throughout the game cannot be customized.

Name

Your character's surname depends on the background you chose earlier, but you can set a first name, or keep the game's default suggestion. This given name appears in conversation, in your character record, and when you target the character in-game.

Appearance

Your character's race and gender determine his or her body type and basic head shape, but from there, all the decisions are yours, from the shape and sizes of features to skin color, tattoos, and cosmetics. To design a unique face quickly, first cycle through the nine presets for your race and gender, then alter individual features using the more detailed sliders grouped by category.

Portrait

Your character's portrait appears on the main combat and exploration screen in-game. Use the sliders in the Portrait area to pose and frame this snapshot however you like—you'll be looking at it a lot. If you create a BioWare/EA profile, you can also upload this portrait to BioWare's community website to use as your avatar in the forums.

Voice

Here, you can choose from one of six different voices (which vary by gender and race) for your character's voice in battle.

Advanced

Once you're satisfied with how you've customized your character, you can select QUICK PLAY (press **Q**) to jump right into the game, in which case the game prompts you to select a difficulty level and then automatically picks appropriate starting attributes, skills, and spells or talents based on your character's class.

However, if you have experience with role-playing games, you might prefer to make these decisions yourself. In that case, select NEXT (just below PRESETS) to continue with advanced character generation. You will find descriptions of the options presented there in the Character Progression section of this manual (see p. 10).

Even if you select QUICK PLAY, we suggest you read the following sections so that you can understand how your character's attributes and abilities affect gameplay.

Difficulty

Whether you select QUICK PLAY after customizing your character's appearance or proceed through advanced character creation, you need to select a difficulty level for combat. You can change this setting at any time in the Options menu. The higher difficulty levels are not meant to present an unwinnable slog; instead, they are meant to maintain the challenge for players who are particularly skilled in the game's tactical combat system. At higher difficulties, enemies become more powerful while your party becomes less so, meaning you need to pause frequently to consider the best approach to each fight.

CASUAL

This setting is best suited to players who are new to role-playing games or expect to play combat in real-time, rather than pausing often to plan tactics. At this setting, party members are immune to friendly fire and heal easily, while enemies inflict less damage than normal.

NORMAL

This is the recommended setting for players familiar with role-playing games, providing a good balance of challenge and survivability. It requires moderate use of tactical pausing to plan actions during combat. Party members are still immune to friendly fire.

HARD

This setting provides a considerably greater challenge than normal difficulty. To prevail against the more aggressive enemy AI, you will need to make sophisticated use of tactical pausing as well as clever combinations of spells and talents. Your party will not heal as easily, and although party members can harm each other with careless use of certain abilities, damage due to friendly fire is only half of what it would be against enemies. Enemies will inflict more damage, be encumbered by status effects for shorter durations, and demonstrate greater resistance to various damage types.

NIGHTMARE

This setting is intended for tactical geniuses who found hard difficulty too easy. Notably, the damage that party members will suffer from careless friendly fire is now equal to the damage the attack would inflict on enemies.

CHARACTER PROGRESSION

In order to survive your adventure, your character needs to become more powerful, learn new skills, acquire advanced equipment, and recruit experienced allies. Whereas the choices described in the Character Generation section of the manual (see p. 6) occur only once, at the beginning of the game, the choices described in this section are repeated many times throughout the game.

ATTRIBUTES

Every character begins with at least 10 points in each of the six attributes, which primarily determine prowess in combat, but also affect your non-combat skills and can reveal new options in dialogue.

When you first see your attribute scores, however, most of them will already exceed 10 because of the cumulative effects of the racial benefits and class benefits described earlier. When you're creating your character, you can distribute a further five attribute points however you like. If you skip advanced character creation, the game chooses for you, spending your five points according to the table at the end of this section. Characters gain a further three attribute points every level.

Note that in many cases, the game rules consider your character's attribute modifier rather than the attribute itself. Quite simply, the attribute modifier is the difference between your current score and the base value of 10—in other words, the total number of points you have chosen to spend on the attribute.

Strength

Greater strength increases the base damage from all weapons except crossbows and mages' staves, and, along with dexterity, determines whether a melee attack is successful. Consequently, strength is particularly important for warriors and rogues, although mages who use melee weapons also find it essential. Great strength is required to wield two-handed weapons or wear heavy armor. Strength also contributes to a character's physical resistance and influences the intimidation side of the Coercion skill.

Dexterity

As the primary component of a character's defense score, dexterity helps sidestep attacks entirely. Along with strength, dexterity also contributes to the melee attack score, which determines whether a swing connects with its target. For ranged weapons, dexterity is the only attribute that contributes to the attack score. Greater dexterity also increases the damage inflicted by piercing weapons like daggers and arrows, since the character is able to maneuver the weapon's tip more deftly. Finally, dexterity contributes to physical resistance and is a prerequisite for some weapon talents. This attribute is most important for warriors and rogues.

Willpower

Willpower affects the size of the pool of mana or stamina that a character can draw from to power spells or talents. This makes it essential for mages, but also very helpful for warriors or rogues who use talents frequently. Willpower also contributes to a character's mental resistance.

Magic

Unsurprisingly, mages gain the most benefit from a high magic attribute; the magic attribute's modifier determines the mage's spellpower, which in turn governs the magnitude of a spell's effect, including damage. For characters of all classes, the magic attribute also increases the effectiveness of healing poultices, potions, and salves. A high magic score is required to wield high-level staves or learn certain spells. Magic also contributes to mental resistance.

Cunning

Characters cannot learn advanced skills unless they possess great cunning, so this attribute is useful for any character who wishes to use skills effectively. It is doubly important for rogues, since many of their class-specific talents are greatly improved by high cunning. Cunning helps characters identify weaknesses in opponents' armor, increasing the armor penetration score, and also contributes to mental resistance and the persuasion side of Coercion.

Constitution

Every point in constitution increases a character's health score, allowing more damage before the character falls on the battlefield. It is thus important for all characters on the front lines of combat. Constitution also contributes to physical resistance.

QUICK-PLAY PICKS

	WARRIOR	MAGE	ROGUE
Attributes	+3 strength +1 dexterity +1 willpower	+2 willpower +3 magic	+1 strength +3 dexterity +1 cunning
Skills	Combat Training		
Talents/Spells	Precise Striking, Shield Block, and/or Shield Bash	Flame Blast and Weakness	Stealth and Dual-Weapon Training

SKILLS

Skills, which are available to all humanoid characters, do not affect combat directly, although some may be used during combat. Rogues gain one skill point every two levels, while warriors and mages gain one skill point every three levels. Each skill has four levels of proficiency, but you must improve your cunning attribute to be able to learn many higher-level skills. You begin the game with two skills pre-determined by your class and background, and can learn one more free skill of your choosing. If you skip advanced character creation, the game chooses for you.

Coercion



Coercion reveals new dialogue options that can convince other characters to change their minds, sometimes revealing new paths through a plot or more favorable terms for a deal. If a Persuade option appears in dialogue, your chance of success is determined by your rank in Coercion and your cunning score. If an Intimidate option appears instead, success depends on Coercion and your strength score.

Stealing



Characters who have learned to steal can attempt to pick the pockets of other characters, whether friendly, neutral, or hostile, although a high rank in the skill is necessary to steal during combat. In most cases, items you receive from stealing are in addition to those that an enemy would normally drop after dying in combat.

Trap-Making



Characters who have learned this skill can construct traps or lures from common components, so long as they also possess a plan to build the mechanism. The second and fourth rank of this skill also increase the range at which the character can detect enemy traps. Note that while all characters who have learned this skill can set traps, only rogues can disarm them.

Survival



Survival lets a character detect enemies who would otherwise be hidden. Higher ranks also bestow bonuses to nature resistance and physical resistance.

Herbalism



Herbalism allows a character to make a wide variety of potions, poultices, salves, balms, elixirs, and so forth, whenever raw ingredients and a recipe are at hand. At higher ranks, the character can complete more difficult recipes, producing particularly potent items.

Poison-Making



Poison-Making focuses on mixing deadly substances that the character can apply to melee weapons, inflicting extra damage and often leaving enemies immobile. Those skilled in this art can also create explosive bombs and flasks designed to be hurled at the enemy. As with Herbalism and Trap-Making, creating items using this skill requires a recipe and raw ingredients. Note that this skill is required not just to create poisons—it is also required to use them.

Combat Training



For warriors and rogues, each rank in this skill opens up a new tier of weapon talents that the character can learn, as well as providing other small benefits. Although mages cannot learn weapon talents, this skill significantly increases the damage they can take from an attack before it interrupts an attempt at casting a spell.

Combat Tactics



Each rank in this skill increases the number of slots available on a character's combat tactics sheet (see p. 26). Since each slot governs one conditional action during combat—for example, instructing a mage to heal any character whose health falls below 50%—having more slots available means you can design more elaborate battle plans for your party.

TALENTS/SPELLS

Talents (for warriors and rogues) and spells (for mages) are special abilities that are unique to a certain type of character, as distinct from skills, which any character can learn. They are almost always related to combat. Using a talent or spell often draws from the character's pool of stamina or mana, although some are passive, providing permanent advantages without stamina or mana expenditure. A character gains one talent or spell each level, as well as at a few other points in the game. You begin with one talent or spell pre-determined by your class and can learn one more of your choosing for free. If you skip advanced character creation, the game chooses for you. Unlike skills, talents and spells do not offer higher ranks; instead, related abilities are grouped in chains of four. Learning a talent or spell unlocks the next ability in that chain—so long as the character meets other prerequisites like character level and attribute scores.

Some spells and talents are available to all characters of that class, and a few groups of talents, like Dual Weapons and Archery, are available to both warriors and rogues. Other spells and talents are linked to a single specialization, which characters can earn later in the game.

There are hundreds of talents and spells in *Dragon Age: Origins*—far too many to list here. Each is described in the game.

Activated Abilities

The most common talents or spells are those marked “activated,” which the current character uses only when directed. (Other characters in your party use their activated abilities whenever appropriate, or whenever the conditional instructions you set up in the combat tactics screen tell them to.) These abilities vary widely—some have positive effects on your character or allies, whereas others act offensively against one or more enemies, or even against everyone in an area, no matter whose side they're on. Some activated abilities are in effect for only a second, while others remain active for a short time. Most activated abilities incur an immediate cost in stamina or mana, although a few are free to use. After you use a particular activated ability, there is a short cooldown period before you can use it again.

Passive Abilities

Talents or spells marked “passive” are permanent effects. They do not consume stamina or mana, and because you do not need to activate them, they do not appear in your battle menu or radial menu. If you wish to review which passive abilities your character has learned, take a look at your spells or talents sheet.

Sustained Abilities

Once you use a talent or spell marked “sustained,” it remains active either until you disable it or until the ability exhausts all of your character's stamina or mana. Some sustained abilities are free to use, and thus remain active for as long as you like. Using a sustained ability is tiring, however, and thus imposes a fatigue penalty, which means that each subsequent ability you use simultaneously with that sustained ability requires more stamina or mana. After you deactivate a sustained ability, there is a short cool-down period before you can use it again.

EXPERIENCE AND LEVELS

Whenever you complete a quest or kill an enemy in combat, you'll earn experience points (sometimes called XP). Once you have enough XP to cross a certain threshold, your character gains a new level; you can see your progress towards that threshold just below the character's name in the main interface or in the character record. It takes 2000 XP to move from level 1 to level 2, and the amount of new experience required for each successive level is 500 XP greater than the previous. (That is, the threshold for level 3 is 4500 XP—2500 XP more than level 2.) There is no hard cap on the number of levels.

At each new level, a character gains the following:

- Three attribute points
- One spell or talent
- Possibly a skill point (every two levels for rogues; every three levels for warriors and mages)
- Several health and mana/stamina points, depending on class (see p. 8)
- A small increase to base attack damage

In the character record, you can specify whether you would prefer to spend attribute points, skill points, and spell/talent points yourself or whether the game should level your characters up automatically.

PARTY MEMBERS

Although it is possible to play through *Dragon Age: Origins* using only the character you create, the game is designed around a party of four adventurers, selected from among the many prospective companions you will encounter throughout Ferelden. Your party members are not just important for combat; they often have personal connections to your quests and may ask for your help with quests of their own. To change which party member you are controlling, press **LB** or **RB** (or both buttons together to control all party members). To change the composition of your party, select CHANGE PARTY in the radial menu. (Some circumstances temporarily prohibit you from changing your party.)

Approval

Your party members have their own agendas and personalities and demonstrate strong reactions to your decisions. You can track a character's approval rating at the bottom of the left side of his or her character record (see p. 20). When party members' approval ratings rise, you are able to engage them in longer conversations at the party camp, which may lead to new quest options or, for certain characters, the possibility of romance. Characters who are confident in your leadership may also earn attribute bonuses. When a party member's approval falls, however, you risk abandonment or betrayal. Because your party members differ so much from each other, it is difficult to keep everyone happy. But the wise general knows that when you disagree on matters of substance, you can always buy loyalty through gifts (see p. 30).

SPECIALIZATIONS

Once any of your characters is sufficiently powerful and you have uncovered certain secret knowledge, you are able to choose specializations relevant to the character's class. The main character can choose two specializations, earning points at levels 7 and 14; other humanoid party members already possess one specialization and can learn one more. Each specialization grants a pair of bonuses and unlocks a new group of powerful talents or spells.

Warrior

BERSERKER



Only half-sane when in the grip of frenzy, a berserker can become a juggernaut of death and damage, although the bloodlust is difficult to sustain.

CHAMPION



The champion is never hard to find on the battlefield, fighting shoulder-to-shoulder with allies, shouting encouragement with robust conviction that leads enemies to despair.

TEMPLAR



Templars are the bane of an errant spellcaster, neutralizing enemy mages' most dangerous abilities so that the party can close for the kill.

REAVER



Reavers are genuine terrors, masochists who flirt with their own death in the hopes of ushering in that of their enemies.

Mage

ARCANE WARRIOR



The arcane warrior is a mage of unconventional means, forsaking the obvious power of direct magical attacks in favor of becoming an elite combatant with conventional weapons.

BLOOD MAGE



The blood mage is a student of forbidden ancient magic that depends less on lyrium or mana than on the pure essence of life. Their spells are ugly weapons, but powerful in the extreme, able to control the wills of others.

SHAPESHIFTER



Studied in the arts of transformation, the shapeshifter is never the adversary that enemies expected they would face.

SPIRIT HEALER



The spirit healer is never rushed, preferring eventual but certain triumph, bolstered by nearly indomitable allies, over flashy demonstrations of offensive power.

Rogue

ASSASSIN



Assassins are efficient killers, able to find weaknesses that they and their allies can exploit to bring an enemy down.

BARD



Only the most innocent of bards consider themselves pure entertainers; many are instead masters of manipulation who hide behind an occupation that provides easy access to people in power. They are not solo fighters, but rather concentrate on inspiring allies or discouraging enemies to tip combat in their favor.

DUELIST



Duelists are masters of speed, evasion, and finesse—never there when the enemy attacks, yet always ready with a disorienting blow or a quick strike at a vital spot.

RANGER



The ranger is a friend to the animals—and, more importantly, their sworn ally. A ranger who needs assistance always finds an extra set of teeth joining battle.

SPECIALIZATION BONUSES

	BERSERKER	CHAMPION	TEMPLAR	REAYER
Attribute Bonus	+2 strength	+2 willpower	+2 magic	+1 constitution
Secondary Bonus	+10 health	+1 cunning	+3 mental resistance	+5 physical resistance
	ARCANE WARRIOR	BLOOD MAGE	SHAPESHIFTER	SPIRIT HEALER
Attribute Bonus	+1 dexterity	+2 constitution	+2 constitution	+2 magic
Secondary Bonus	+5 attack	+2 spellpower	+1 armor	Extra health regeneration
	ASSASSIN	BARD	DUELIST	RANGER
Attribute Bonus	+2 dexterity	+2 willpower	+1 dexterity	+1 constitution
Secondary Bonus	+2.5% critical chance	+1 cunning	+1 damage	+5% nature resistance

QUESTS

Dragon Age: Origins is a game built on story, not a simple brawler—you need to talk, reason, and explore your way through the world rather than simply seeking out the next fight. The game is composed of hundreds of small quests that build into an overarching, epic tale. Nearly every quest has multiple possible paths and multiple outcomes. The easiest way through a quest is to look for the next plot point marked on your mini-map or the next character with an exclamation mark over her head. More creative players will find they can shape the story in unexpected—even disturbing—ways.

CONVERSATION

Some conversations start by themselves—like at the beginning of your background story—but most of the time, you need to approach other characters for help or information. (Don't forget to talk to your own party members—they might know more than you think.) If a speech-bubble icon appears when you target a character, just press **A** to begin conversation. Whenever it's your character's turn to speak, you'll have several options for what to say. Select the line you prefer and press **A**. Choose carefully: the vastly different outcomes of certain choices may not be evident until much later in the game.

Persuasion

Some player lines begin with "(Persuade)" or another prefix. If your skill is sufficient, the character you're talking to will bend to your logic, but if you fail, you might find yourself in a worse position than you were before. Persuade lines depend on your character's rank in Coercion and the cunning attribute.

Intimidation

Intimidation is the flip side of persuasion: it still depends on the Coercion skill, but is influenced by your character's strength attribute rather than cunning. There are fewer opportunities for intimidation than there are for persuasion, but the results can be more dramatic. As with persuasion, the price for failing an intimidate check can be steep.

Other Attribute Checks

Some other special lines check your character's attribute scores. For example, you might see a line prefixed "(Cunning)" where your character displays unique insight. If your attribute is high enough for the situation, other characters will respond favorably; if not, they might think less of you.

JOB BOARDS

Several organizations in Ferelden maintain job boards in the hopes that they will find assistance from some adventurer in need of coin. The most common of these boards belong to the chanters, religious folk who take an oath never to utter a sentence that isn't in the Chant of Light. Since it is exceedingly rare that a job can be described using only the words of the holy scripture, the local chanter posts written requests on a nearby board. Once you complete a task, return to the chanter for payment. You can also find similar boards run by smaller local groups.

JOURNAL

Your journal is a record of every quest you've discovered. It provides some background on what you need to do and why, and sometimes—although not always—hint at alternate solutions to the problem. Although you can work on many quests simultaneously, only one can be marked as your active quest, as denoted by two large arrowheads beside the quest. The main interface and your area map only display points of interest for the active quest.

In the journal, the tab marked with an arrow icon displays incomplete quests, whereas the tab marked with a checkmark displays quests you've finished, just in case you want to review.

Codex

Your codex, which you'll find under the tab of your journal marked with an icon of a sheet of paper, stores information you've found about life in Thedas and about playing the game. Sometimes, these are excerpts from books you've found; other times, they take the form of encyclopedia entries on a topic. You can find codex entries by examining objects in the world, by asking about certain topics in conversation, or by killing enemies—and when you encounter new aspects of gameplay, the codex category called Controls often updates with an explanation.

Pay particular attention to codex entries in the Quest-Related category. These usually provide information vital to completing your plots.

Conversation History

The fourth tab in your journal, marked with a speech-bubble icon, provides a record of the 25 most recent conversations, letting you review the details of what someone said. Don't worry about conversations cycling out of this list: the journal itself always reflects major plot points.

Downloadable Content

The final tab in your journal, marked with a treasure-chest icon, displays new content that you can download to extend the game. This is similar to the downloadable content screen accessible from the main menu.

MAPS

Dragon Age: Origins features two types of maps—area maps that appear mostly incomplete when you enter an area, yet gain new details as you explore, and a world map used to travel between areas. The mini-map in the top-right corner of the game screen shows only a small section of the area map.

The world map (actually just a map of the nation of Ferelden—Thedas as a whole is much larger) becomes available once you complete the game's prologue. In the upper-right inset is your party camp, where you can visit with your party members and automatically heal characters of injuries. Be wary when traveling between locations on the world map; hostile parties often ambush adventurers.



WWW.DRAGONAGE.COM



LABEL	EXPLANATION
1	Character's health (p. 21)
2	Character's mana/stamina (p. 21)
3	Character's current action
4	Character taking damage (red fog)
5	Level-up notification (p. 13)
6	Currently selected character
7	Fallen party member
8	Selected character's health and mana/stamina
9	Buttons for battle-menu shortcuts
10	Primary battle-menu shortcuts
11	Secondary battle-menu shortcuts
12	Ability with cooldown meter

LABEL	EXPLANATION
13	Useable item and quantity in inventory (p. 30)
14	Status effects on character (p. 25)
15	Mini-map of area (p. 17)
16	Damage to enemy (p. 22)
17	Critical-hit damage (p. 23)
18	Damage to party member
19	Spell or talent in use
20	Current target's name/health
21	Flanking arc (p. 21)
22	Current target
23	Selected character
24	Non-selected party member

COMBAT

Although magic works somewhat differently, most combat follows a straightforward mechanic: the difference between the aggressor's attack score and the opponent's defense score, plus about 50, is the percentage chance of the attack's success. If it is, the target suffers a certain number of points of damage subtracted from current health. However, each of those statistics—attack, defense, and damage—can be modified by a number of additional factors, as explained in the following pages.



LABEL	EXPLANATION
1	Cycle through screens
2	Journal (p. 17)
3	Map (p. 17)
4	Inventory (p. 29)
5	Character record
6	Skills (p. 11)
7	Spells/Talents (p. 13)
8	Cycle through characters
9	XP towards next level (p. 13)
10	Approval (p. 14)
11	Health (p. 21)
12	Mana/Stamina (p. 21)
13	Race (p. 6)
14	Class/Specializations (p. 7/14)

LABEL	EXPLANATION
15	Armor (p. 22)
16	Defense (p. 22)
17	Attack/SPELLpower (p. 21, 25)
18	Damage (p. 22)
19	Fatigue (p. 21)
20	Status effects (p. 25)
21	Attributes (p. 10)
22	Physical/Mental resistance checks (p. 25)
23	Elemental resistance (p. 23)
24	Scroll for more statistics
25	Current combat tactics (p. 26)
26	Explains selected statistic
27	Level up (p. 13)
28	Open combat tactics menu

HEALTH

Whenever a character takes damage, points are subtracted from his or her pool of total health points. Maximum health is initially determined by the character's class (see p. 8); it increases with each level and with each point spent in the constitution attribute. Lost health regenerates, but does so much less quickly in combat than in exploration. If you're running low on health during combat, apply a health poultice (see p. 30) or cast a healing spell.

STAMINA/MANA

Warriors and rogues draw from a pool of personal stamina to power many of their talents, and mages use their mana for spells. (A few abilities, however, are free to use.) Characters regain their stamina or mana over time, but they do so more slowly when in the heat of battle, which means they can only use a limited number of abilities concurrently. Particularly at lower levels, when characters' reserves of stamina and mana are limited, talents and spells are special supplements to basic attacks, not the focus of battle. The size of the stamina or mana pool is initially determined by the character's class (see p. 8). It increases with each level and with each point spent in the willpower attribute.

Fatigue

The weight of armor or a shield is taxing when characters are engaged in strenuous combat, imposing a fatigue penalty on top of the regular cost of talents or spells. Fatigue is applied as a cumulative percentage tax, so if a character is wearing gloves with a fatigue rating of 2.5% and boots with a fatigue rating of 3%, all talents or spells consume 5.5% more stamina or mana than normal. For front-line characters, the price of fatigue may be well worth the protection that armor provides, but characters who hang back from close combat in order to concentrate on talents or spells may find they're better off wearing regular clothing. Sustained abilities also impose fatigue (see p. 12).

ATTACK

The attack score is a combination of a character's base attack, which varies by class (see p. 8), plus half of the character's strength and dexterity modifiers (or, for ranged attacks, no strength modifier but the full dexterity modifier). Talents, spells, skills, status effects, high-quality equipment, and the difficulty level can further alter this score.

Flanking

When striking from directly behind a target, an attacker gains a large bonus to attack as well as an increased chance to score a critical hit. These bonuses gradually diminish the further the attacker moves around the side of the target. The black segment of the red ring around an enemy's feet shows the flanking area. Certain talents can fully or partially protect a character from being flanked. (For rogues, successful flanking attacks are backstabs—see p. 23.)

Range

Attacks with ranged weapons maintain normal attack scores so long as the attacker is sufficiently close to the target—within the range specified in the weapon's statistics, which is expressed in meters. If the attacker exceeds this distance, the attack score begins to drop precipitously, making it difficult to hit the target.

Cover

Arrows and crossbow bolts cannot penetrate obstacles like tables, columns, or barrels. Although it is possible to target and fire at opponents behind cover, the attacks do not hit them, no matter how high the attack score is.

DEFENSE

Defense represents a character's ability to avoid attacks entirely. The score is a combination of the character's base defense, which varies by class (see p. 8), plus the character's dexterity modifier. Shields, talents, spells, skills, status effects, high-quality items, and the difficulty level can further alter this score, but note that while shields do contribute directly to defense, armor does not—instead, armor mitigates damage received, as described below.

Missile Defense

Each character has a separate invisible score for defense against missile attacks from enemy archers, letting a character shrug off ranged attacks. Shields contribute more to missile defense than they do to regular defense, and some spells or talents increase a character's missile defense directly.

DAMAGE

Base damage is a combination of the weapon's damage rating and—for attacks from all weapons except crossbows and mages' staves—the attacking character's strength modifier. (Note that when a character is wielding two weapons, the strength modifier is halved for the off-hand weapon; for a two-handed weapon, the strength modifier is increased by 50%.) Characters also gain a small bonus to base damage every time they gain a level, and the damage from piercing weapons like daggers and arrows is also affected by dexterity, since a more nimble character can position them for maximum effect. Talents, spells, status effects, high-quality items, and the difficulty level can further alter this base number. The damage number that you see in your character record is adjusted for the relative speed of the weapon, so it's difficult to replicate the math precisely.

Armor and Armor Penetration

Armor mitigates damage—if a target has an armor rating of 10, it suffers 10 fewer points of damage than the attack would normally inflict. Regardless of armor rating, a successful hit always deals at least one point of damage.

However, every weapon has an armor penetration score, which essentially reduces the target's armor rating before final damage is calculated. This means that the armor penetration score is effectively equivalent to extra damage, although damage multipliers like critical hits do not multiply armor penetration. As well, if the armor penetration score is greater than the target's armor score, the excess armor penetration does not inflict damage.

Damage Types and Colors

There are five types of elemental damage—fire, cold, electricity, nature, and spirit. Many weapons, coatings, or spells inflict one or more types of elemental damage in addition to the basic physical damage. Electricity damage also drains a character's stamina or mana.

You can identify different types of damage by the color of the text it appears in:

- ☞ Damage to your party is red, no matter what the type
- ☞ Physical damage—from your party's normal attacks or from abilities—is white
- ☞ Fire damage is orange
- ☞ Cold damage is blue
- ☞ Nature damage is medium green
- ☞ Electricity damage is yellow
- ☞ Spirit damage is purple
- ☞ Healing is bright green prefixed by a + symbol
- ☞ Any type of elemental damage that is additional to an attack's normal damage (from enchantments, for example) is also indicated with a + symbol

Elemental Resistances

Elemental damage is subject to resistances, which certain enemies may possess innately, or which characters gain through spells, talents, skills, or items. If a character has 10% resistance to fire, all fire damage is reduced by 10%. Conversely, characters can become vulnerable to the elements, in which case they suffer increased elemental damage.

When combatants are completely immune to a certain type of damage, "Immune!" may appear over their heads, colored using the same scheme as damage text. Note that immunity is only displayed when the damage of that type exceeds a certain threshold—if you would have only inflicted a couple of points of fire damage anyway, the game doesn't announce the resistance, in order to concentrate on communicating more vital information.

Note that these elemental resistances are distinct from physical and mental resistance, which describe a character's ability to resist certain status effects.

Critical Hits

Every attack has a small chance to generate a critical hit, which inflicts up to double the normal attack damage after accounting for armor. Flanking attacks increase the chance of a critical hit, as do certain spells, talents, and items. Damage from critical hits is displayed in larger text size than regular damage.

Backstabs

Whenever a rogue flanks an enemy, the attack is an automatic backstab—similar to a critical hit, except that some rogue talents can make backstabs more powerful than critical hits.

Strength Modifiers

Most weapons possess a strength modifier property. This indicates the proportion of the character's strength modifier that is added to damage. Since it is a property of the weapon, not related to how the weapon is used, it is distinct from the changes to the strength modifier that result from wielding dual weapons or two-handed weapons (see p. 24).

INJURIES

So long as at least one of your party members survives a fight, those who fall in combat revive themselves once all enemies are dead—but their sustained injuries apply penalties to their attributes. To remedy an injury, use an injury kit on the character or rest up in your camp. Injuries are visible in the status effects section of the character record and as a small icon just above the battle menu during gameplay.

ENEMY RANKS

The text that enemies' names are displayed in is color-coded to indicate their relative threat:

- ☞ The names for critter- or normal-rank enemies are white
- ☞ The names for elite-rank enemies are yellow
- ☞ The names for boss- or elite-boss-rank enemies are orange

WEAPON STYLES

The number and type of weapons a character is wielding affects attack, damage, and in some cases defense. Each character can have two different sets of weapons equipped simultaneously, although only one of the sets will be active and in the character's hands. Generally, one set of weapons is for melee combat and one for ranged, but there's no reason a character can't switch between dual weapons and a two-handed weapon, or between a bow and a crossbow, or between a mage's staff and a sword. To equip the character's second weapon set, either select SWAP WEAPON SETS from the ADVANCED section of the radial menu or press **START** when you're in the inventory screen.

Single Weapon

A character who is carrying a single one-handed weapon does not earn any special bonuses or suffer any special penalties. This is the normal approach to combat, and early in the game, most warriors and rogues are most effective using this style. There are no weapon talents specifically associated with the single-weapon style, however, so growth potential is limited.

Weapon and Shield

Adding a shield to a single one-handed weapon does not alter the character's attack or damage scores, although the character's defense and missile defense both increase on account of the shield. Carrying a shield requires moderate strength, however, and as with armor, shields increase the character's fatigue, meaning that talents or spells consume more stamina or mana. Warriors have access to the weapon-and-shield school of talents, which teach them how to use the shield as an offensive weapon as well as how to increase its defensive capabilities, including protection from flanking attacks.

Dual Weapons

A character can increase the frequency of attacks by carrying a regular one-handed weapon in one hand and a small weapon like a dagger in the off-hand, although these attacks are generally less effective than strikes from a single weapon, since the off-hand weapon only gains damage equal to half the character's strength modifier. (The combined damage of the two weapons may or may not exceed the damage from wielding only one of them.) Warriors and rogues have access to the dual-weapon school of talents, which teach them how to use two weapons more efficiently, reducing the penalties for using dual weapons, as well as how to execute synchronized attacks with both weapons. A master of dual weapons can eventually wield two full-size one-handed weapons.

Two-Handed Weapon

Merely hefting a two-handed weapon requires great strength, and although the weight means that characters attack more slowly, two-handers inflict enormous damage with every hit. The character's contribution to the damage score for a two-handed weapon includes 1.5 times the character's strength modifier, whereas a one-handed weapon uses the unaltered strength modifier. Warriors have access to the two-handed school of weapon talents, which teach them how to make even more powerful—if ungainly—attacks, including hits that incapacitate enemies or destroy their armor or weapons.

Mage's Staff

Mages' staves are unlike other weapons: they take two hands to control, but mages do not use staves for direct melee attacks. Instead, they fire magic projectiles that never miss—the mage's attack score is irrelevant. Damage is determined by the staff's own power and the mage's spellpower score (itself affected by the magic attribute—see p. 25). Unlike spells, the staff does not consume mana, so there is no worry of being left defenseless if you expend all of your mana.

Bow

Archery lets a character deal death at great range, but be aware that archers who take damage from melee attacks may lose concentration, slowing their rate of fire. Among the various types of bows, shortbows are the fastest to fire, but have limited range and punch. Longbows are moderately powerful and can hit targets at much greater distance, but fire more slowly than shortbows. Crossbows have the greatest range and intrinsic damage, particularly against armored enemies, but take significant time to reload. Unlike shortbows and longbows, crossbows do not gain extra damage based on a character's strength modifier, so particularly strong characters may do less damage with a crossbow—although since merely wielding a longbow or shortbow requires significant dexterity, only well balanced characters are able to use all types of high-quality bows. Warriors and rogues have access to the archery school of talents, which teaches them how to fire a number of trick shots and how to better protect themselves while wielding a bow or crossbow.

MAGIC-SPECIFIC RULES

Magic, unsurprisingly, works differently from normal combat—otherwise, it wouldn't be magic! These trade-offs can leave mages at a disadvantage when fighting alone or forced to use conventional weapons, yet they ensure that mages are particularly fearsome when supported by a well-balanced party or controlled by a player with a deep understanding of the rules of magic.

Spellpower

A mage's spellpower score determines the effectiveness of spells, the damage from a staff's magic projectile, and the potency of potions, poultices, and salves. The spellpower score is simply the number of points above 10 that the mage has learned in the magic attribute, although abilities, status effects, mages' staves, or other high-quality items can alter the spellpower score. The effect of greater spellpower differs from spell to spell; the simplest explanation is that greater spellpower never hurts. Some mages' staves apply two spellpower bonuses; these effects are cumulative.

Spell Interruption

Because it takes great concentration to cast a spell, a mage who takes damage while preparing a spell may be interrupted. The mage can always attempt the spell again, but the delay makes the mage less effective in combat. More ranks in the Combat Training skill increase the amount of damage a mage can take before being interrupted.

Spell Combinations

When two opposing or complementary spells collide, the effects can be unusual and potent. There are 10 possible spell combinations in the game. Only a few of these are hinted at ahead of time—for the most part, you must find them for yourself. Once you have discovered a spell combination, a description of how to replicate the effect appears in your codex.

Friendly Fire

Many spells (as well as traps, grenades, and some hostile creatures' special abilities) are indiscriminate in who they target, or are targeted on an area rather than a single opponent. They harm—or, in some cases, help—everyone nearby, not just your adversaries or just your allies. If you set a trap, only your enemies can trip it, but your party members may still suffer the effects of the trap if they're nearby when it goes off. Be careful!

STATUS EFFECTS

Many items, talents, and spells have effects on the target beyond simple damage. Sometimes these effects are as simple as knocking opponents to the ground, but the more complex effects described below persist for a time.

Most of the time, combatants have a chance to resist status effects. Their chance of doing so depends on either the physical or mental resistance score, as appropriate to the effect.

Physical Resistance

For physical effects like being knocked to the ground or rooted in place, the game compares one of the attacker's relevant attribute modifiers—strength for most talents and magic for most spells, although rogue-specific talents usually use cunning—to the defender's physical resistance score. If the physical resistance score is higher, the status effect does not apply. Physical resistance is half of the total of the character's strength, dexterity, and constitution modifiers.

Mental Resistance

For mental effects like being put to sleep or stunned, the game compares one of the attacker's relevant attribute modifiers—cunning for most talents and magic for most spells—to the defender's mental resistance score. If the mental resistance score is higher, the status effect does not apply. Mental resistance is half of the total of the character's willpower, magic, and cunning modifiers.

Stun/Paralysis/Fear/Immobility/Petrifaction

These status effects all prohibit the affected combatant from taking any action, including aborting their current actions. The visual effects are different, however, and they may react differently in combination with subsequent effects. Petrified characters, for example, can sometimes be shattered by critical hits or other effects.

Disorientation

A character who is disoriented can still fight, but is less likely to hit enemies and more likely to be hit personally, since the effect applies penalties to attack and defense.

Sleep

A combatant who has been put to sleep is unable to attack and is unlikely to resist further effects, but awakens as soon as an aggressor inflicts further damage.

Charm

Charmed enemies fight as an ally of the player for the duration of the effect. The main character, party members, and other player allies are immune to charm effects.

COMBAT TACTICS



LABEL	EXPLANATION
1	Change current behavior
2	Change current preset
3	Asterisk indicates modified preset
4	Select to rearrange tactics
5	Select to disable this tactic

LABEL	EXPLANATION
6	Who this condition applies to
7	What criteria this condition measures
8	Action to take when condition is true
9	Explains selected behavior
10	Enable/Disable all tactics for this character

Once you have the hang of basic combat strategy, you're ready to use combat tactics that help your party members work together efficiently without needing constant direction. Although the combat tactics screen—which you access by pressing **T** from the character record—looks complicated at first, it's built around one simple idea: if the first condition on the left side of the screen is true, execute the corresponding action on the right side of the screen; if the condition is not true, check whether the next condition is. You must always control the current character directly, but the other members of your party follow whatever tactics you command.

Behavior

The behavior menu at the top of the tactics screen controls the character's general approach to combat, like when to attack, what distance to try to keep from enemies, when to give chase, and when to switch between ranged and melee weapons. Essentially, behaviors are generic reactions, whereas tactics are specific actions. Press **T** while you have the behavior menu selected to read a description of the current behavior.

Basic Tactics

As your characters learn new spells and talents, the pre-built tactics (like Archer, Defender, or Scrapper) automatically populate with combinations of conditions and actions. For example, the Healer preset might appear empty for Morrigan at first, but tactics fill in automatically when she learns the Heal spell. Select a tactics preset that corresponds to the sorts of actions you want the character to take. The more similar abilities that character learns, the more tactics will fill in.

Custom Tactics

You can also create your own custom sets of tactics, either by modifying the presets or starting from scratch with the preset marked CUSTOM. If you modify a preset, it will become the custom set; since there is only one set of custom tactics, modifying a preset will overwrite your existing custom tactics.

Let's say we want to add a new tactic that tells the character to use a health poultice when his or her health falls too low. First, select on a condition slot on the left side of the screen and press **A**. From the menu that appears, first select which character you want to evaluate. For this condition, we want to check the character's own health, so pick SELF. Now another menu opens; select HEALTH, then < 50%. That's your first condition: whenever that character's health is less than half, the game sees that this condition is true and activates the corresponding action.

Now you need to set up the action. Select the slot on the right side of the screen next to the condition you just created, then press **A**. Select USE HEALTH POULTICE: LEAST POWERFUL. (Save your strong health poultices for the really dire situations; if this one isn't strong enough, the condition activates again and use another poultice.)

That's it! Tactics always evaluate from the top down, so urgent requirements like healing should usually go at the top. You can move a tactic up or down by selecting the number in front of it and pressing **A**. You can also disable an individual tactic by selecting the + symbol just after its number.

Tactics are particularly powerful when they help different party members support each other. For example, if Morrigan is in your party and knows a healing spell, you can tell her to monitor all your party members simultaneously and heal anyone in need. Since mages are weak in close combat, you can then direct your warrior to always attack enemies who are targeting the mage (Enemy > Attacking Party Member > Attacking Morrigan).

As your characters level up or learn additional ranks in the Combat Tactics skill, you gain more condition/action slots on the screen, permitting more complicated battle plans.

ITEMS

There are hundreds of unique items in *Dragon Age: Origins*, corresponding to five major groups—useable items like health poultices or traps, crafting items like recipes or raw ingredients (which are themselves often useable), plot items like keys or letters, gifts for your party members, and items like weapons, armor, or accessories.



LABEL	EXPLANATION
1	Cycle through screens
2	Journal (p. 17)
3	Map (p. 17)
4	Inventory
5	Character record
6	Skills (p. 11)
7	Spells/Talents (p. 13)
8	Cycle through characters
9	Current weapon set (p. 23)
10	Slot with equipped item
11	Slot that selected item would use
12	Change weapon sets
13	Health (p. 21)
14	Mana/Stamina (p. 21)
15	Armor (p. 22)
16	Defense (p. 22)
17	Attack (p. 21)

LABEL	EXPLANATION
18	Damage (p. 22)
19	Fatigue (p. 21)
20	Weapons tab
21	Armor tab
22	Accessories tab
23	Useable items tab
24	Crafting items tab
25	Other items tab
26	Plot items tab
27	Junk tab
28	Item name/material (p. 29)
29	Inventory capacity
30	Backpacks purchased
31	Total currency (p. 30)
32	Inspect/Compare selected item
33	Equip/Unequip selected item
34	Move selected item to junk tab

INVENTORY

Your inventory stores all the items you purchase or find in your journey through Ferelden. Here, you can compare items' relative statistics and equip your party members for battle. You can only carry so much equipment, however; once your inventory is full, you have to sell some items or destroy them before you can pick up more. You can also increase your capacity by purchasing a backpack.

To inspect an item, highlight it and press **X**. This will display the item's various properties, which are explained throughout this manual. If you have another item of the same type equipped, you will compare the new item side-by-side with your current equivalent.

To equip or unequip an item, press **A**. To use most useable items, press **B** to exit the inventory, then pull **T** to open the radial menu. From the radial menu, you can use such items directly or map them to the battle menu, just like a skill, spell, or talent. To use a few special items like gifts for party members or books that improve your character's statistics, select the item in the inventory and press **A**.

When you find an item in the inventory that you don't think you'll use, press **V** to send it to the junk tab. Junk items still count towards your inventory capacity, but when you visit a store, you can sell them all with a single button-press. When you're looking at the junk tab, you can also destroy items to free up inventory space by pressing **V**.

CONTAINERS/LOOT

Whenever an object in the world or an enemy corpse is shimmering, it contains items that you can pick up, presuming you're able to open the container and have space in your inventory. Many doors and chests are locked when you find them. To open a lock, you either need a key—which doesn't always exist—or a rogue to pick the lock. All rogues have some skill in picking locks, but they get better with each additional talent in the lock-picking tree and with each point in the cunning attribute. If you don't want to miss out on good loot, recruit a rogue!

MATERIALS

Each weapon or piece of armor indicates what type of material it is made from. There are seven tiers each in three different material chains—leather, metal, and wood. Within a given chain, items made from higher-tier materials always offer better statistics.

ITEM SETS

Certain combinations of items from the same set—not just made from the same material type, but usually bearing similar names, like Dalish Boots, Dalish Armor, and Dalish Gloves—offer an extra bonus when equipped simultaneously. When you are receiving an item-set bonus, an icon appears in the status effects section of the character record. To see which of your items offer set bonuses, and to learn precisely what the bonus is, examine the items and read their descriptions. If you manage to find two whole sets of items that can be equipped simultaneously, the bonuses are cumulative.

ITEM POWERS

Equipment sometimes improves (or even diminishes) your characters' statistics. When inspecting an item in your inventory, positive effects are colored green and negative effects are colored red. These bonuses or penalties come into effect when you have the item equipped. Be aware, however, that these bonuses do not count toward the requirements to learn new abilities; since learning the Indomitable talent requires 28 strength, the character must have 28 points in the strength attribute when no other items are equipped and no temporary spells or talents are active.

RUNES

High-quality weapons can be improved by having an enchanter inscribe one or more lyrium runes on the weapon. Runes can be found throughout Ferelden, but enchanters and weapons of sufficient quality are both somewhat rare. Once a rune has been inscribed, its properties are added to the item. The rune is not destroyed in the process, nor is it permanently bonded to the weapon; if you find a better rune later on, you can return to an enchanter to replace the rune.

GIFTS

You will find some items identified as gifts. To give a gift to one of your party members, open your inventory, switch to the appropriate party member, then select the item and press **A** to give it to the character. If the character accepts your gift, his or her approval of you increases. Different characters prefer different sorts of gifts; if you give a party member his or her favorite type of gift, the approval increase is greater. Some gifts are so well suited to particular characters that other party members completely refuse to accept the gift themselves. However, the more gifts you give each party member, the less he or she will be interested in the next gift. The camp is a handy place to give gifts because you can see your whole party at once.

CURRENCY

Ferelden uses three types of coinage: copper pieces called bits, silver pieces called silvers, and gold pieces called sovereigns. There are 100 bits in a silver and 100 silvers in a sovereign. For convenience, the game automatically converts your money into the least possible coinage, so if you have 80 bits and find 40 more, you end up with one silver and 20 bits. Your current supply of money is displayed at the bottom of the inventory screen.

STORES

Merchants throughout Ferelden offer new equipment for sale and also purchase unwanted items, putting coin in your pocket and freeing up room in your inventory. To buy items, select them on the merchant's side of the inventory (the left); to sell items, select them on your side (the right). You can also sell every item in your junk tab at once by pressing **V**. The different tabs at the top of the inventory screen, which you can cycle through by pulling **LB** or **RB**, determine which type of items you're looking at. The second-last tab allows you to buy back or sell back items that you purchased accidentally with no loss of money so long as you haven't left the store yet.

CRAFTING

Characters who have learned the Herbalism, Trap-Making, or Poison-Making skills can create their own items if they possess a recipe or plan for the item and the constituent ingredients. You'll find recipes and ingredients in merchants' shops and throughout Ferelden.

Once you have a recipe or plan, open the crafting interface by selecting the appropriate skill from either the Poisons and Traps or Potions segments of the radial menu. Your recipes appear on the left; after selecting a recipe, the required ingredients appear on the right along with an indication of your current supply. If you have sufficient stock of ingredients, you can create the item immediately. Note that creating more powerful items requires higher ranks of the appropriate crafting skill.

QUICK-USE ITEMS

You can use consumable inventory items directly from the radial menu (usually in the Potions or Poisons and Traps segments) or map them to slots in the battle menu just as you would do with a skill, spell, or talent. Many of the consumable items described below come in formulations of different strength.

Health Poultices

Health poultices instantly restore some amount of health, although they do not treat persistent injuries. The Quick Heal option in your radial menu will make your character use a health poultice from the party inventory. In the options screen, you can configure whether Quick Heal always uses the weakest health poultice available (meaning you might need to use Quick Heal several times, but will free up inventory space) or uses the most appropriate strength of poultice.

Injury Kits

Injury kits treat the injuries that characters suffer when they fall unconscious in combat. These kits also restore some health.

Lyrium Potions

Lyrium potions instantly restore some amount of a mage's mana. Warriors and rogues cannot use lyrium potions.

Elemental Salves

Ice salve and similar substances temporarily increase a character's resistance to damage from the associated element.

Weapon Coatings

Flame coating and similar substances can be applied to a character's melee weapons, temporarily inflicting damage from the associated element on every attack.

Poisons

Like elemental weapon coatings, poisons are applied to a character's melee weapons, but poisons usually also have a chance to apply a status effect like paralysis in addition to the nature damage they inflict.

Grenades

Grenades are explosive flasks or bombs that characters can throw at their enemies, inflicting some type of elemental damage—although they may also harm allies, if not aimed carefully.

Traps

Traps spring on the first enemy to come near them. Depending on the type, traps inflict either damage, a status effect, or both. Some traps affect an entire area—including allies in the vicinity, hence the warnings they carry about friendly fire—whereas others affect only the enemy that triggers them. To resist a trap's status effect, the victim must pass a check against the cunning score of whoever set it. Rogues can disarm the party's own traps or attempt to disarm enemy traps by selecting the trap and pressing **A**. A trap only fires once.

Lures

Lures are like traps, except that they attract enemies all on their own, even grabbing their attention during combat. Lures can only be used once, although some lures remain in place for a while, distracting multiple enemies.

Mabari Crunch

Mabari crunch is a dog treat that treats persistent injuries and instantly restores some amount of health and stamina.

OTHER QUICK-USE ITEMS

You will discover many other miscellaneous consumable items—but be aware that they are often more useful when mixed together to make more powerful items, following the directions of a crafting recipe.

XBOX LIVE

Play anyone and everyone, anytime, anywhere on Xbox LIVE®. Build your profile (your gamer card). Chat with your friends. Download content (TV shows, trailers, HD movies, game demos, exclusive game content, and Arcade games) at Xbox LIVE Marketplace. Send and receive voice and video messages. Use LIVE with both Xbox 360® and Windows®. Play, chat, and download on both your PC and your Xbox 360. LIVE gives you ultimate access to the things you want and the people you know, on both your PC and your TV. Get connected and join the revolution!

REGISTRATION AND SUBSCRIPTION REQUIRED TO ACCESS ONLINE FEATURES. EA ONLINE TERMS & CONDITIONS AND FEATURE UPDATES ARE FOUND AT WWW.EA.COM. YOU MUST BE 13+ TO REGISTER WITH EA ONLINE. EA MAY PROVIDE CERTAIN INCREMENTAL CONTENT AND/OR UPDATES FOR NO ADDITIONAL CHARGE, IF AND WHEN AVAILABLE. EA MAY RETIRE ONLINE FEATURES AFTER 30 DAYS NOTICE POSTED ON WWW.EA.COM.

CONNECTING

Before you can use Xbox LIVE, connect your Xbox 360 console to a high-speed Internet connection and sign up to become an Xbox LIVE member. For more information about connecting, and to determine whether Xbox LIVE is available in your region, go to www.xbox.com/live/countries.

FAMILY SETTINGS

These easy and flexible tools enable parents and caregivers to decide which games young game players can access based on the content rating. And now, LIVE Family Settings and Windows Vista Parental Controls work better together. Parents can restrict access to mature-rated content. Approve who and how your family interacts with others online with the LIVE service. And set time limits on how long they can play. For more information, go to www.xbox.com/familysettings.

CREDITS

BIOWARE

Dragon Age: Origins Senior Leadership

Executive Producers and Project Directors: Mark Darrah, Dan Tudge

Lead Designers: Brent Knowles, Mike Laidlaw, James Ohlen

Art Director: Dean Andersen

Lead Programmer: Ross Gardner

Project Manager: Benoit Houle

Quality Assurance Lead: Nathan Frederick

Online Producer: Fernando Melo

Art and Animation

Cinematic Animators: Tony de Waal (Lead), Carlos Arancibia, Edward Beek, Katie Cibinel, Tim Golem, Suhas Holla, Andrew Hunt, Greg Lidstone, Hugo Morales, Bobby Stockport, Nathan Zufelt, Steven "Ed" Herft (DICE), Jesper Skoog (DICE)

In-Game Animators: John Santos (Lead), Julio Alas, Ceri Harrison, James Humphreys, Rick Li, Arneil Marquez, Marc-Antoine Matton, Michael Milan, Cody Paulson, Clove Roy

Technical Animators: Charles Looker (Lead), Yunus "Light" Balcioglu, Cristian Enciso, Kevin Ng, Steve Ruhnham

Additional Animation: Parrish Ley, Ray Lim, Joel MacMillan, Dave Wilkinson, Carman Cheung, Nick DiLiberto, Paul Dutton, Steve Gilmour, Chris Hale, Pasquale LaMontagna, Cliff Mitchell, Kees Rijnen

Senior Artist: Matthew Goldman

Character Artists: Shane Hawco (Lead), Bobby Bath, Leroy Chen, Ken Finlayson, Jae Keum, Francis Lacuna, Ryan Lim, Herbert Lewis, Dustin Nelson, Ramil Sunga

Concept Artists: Fran Gaulin, Sung Kim

GUI Artists: Warren Heise (Lead), Tyler Lee

Level Artists: Ian Stubbington (Lead), Casey Baldwin, Boali Dashtestani, Andrew Farrell, Mike Hong, Steve Klit, Andrew Knight, Rohan Knuckey, Toby Manthorpe, Ben McGrath, Sheila Nash, Young Park, Andre Santos, Lee Scheinbeim, Gina Welbourn, Charlie Wong

Technical Artists: Daniel Fedor (Lead), Jean-Sebastian Baril, Brian Chung, Kevin Hayes, Suhwan Pak

Visual Effects Artists: Alim Chaarani (Lead), Terrence Kim, Casper Konefal, Jacky Xuan

Additional Art: Joy Ang, Ben Carriere, Rion Swanson, Nick Thornborrow, Jaemus Wurzbach, Sasha Beliaev, Adrien Cho, Tristan Clarysse, John Gallagher, Mike Grills, Rod Green, Todd Grenier, Lindsay Jorgensen, Edward Kwong, Christopher Mann, Jessica Mih, Matthew Park, Tom Rhodes, Shareef Shanawany, Sean Smalles, Jason Spykerman, Rob Sugama, Brian Sum, Shane Welbourn, Dave Hibbelen (Former Director of Art)

Director of Art and Animation: Alistair McNally

Audio, Localization, and External Resources

Audio Director: Simon Pressey

Associate Audio Producer: Marwan Audeh

Audio Designers: Matt Bestler, Real Cardinal, Vance Dylan, Jordan Ivey, Michael Kent, Michael Peter, Steven Sim, Jeremie Voillot

Voice-Over Producer / Director: Caroline Livingstone

Assistant External Producers / Director: Melanie Fleming, Steve Lam, Heather Rabatich

Localization Producer: Jenny McKeareny

Localization Project Manager: Flor Garcia Ruiz

Assistant Localization Producer: Jason Barlow

External Producer: John Campbell

Additional Audio: Ellen Lurie

Director of Audio, Localization, and External Resources: Shauna Perry

Design

Cinematic Designers: Ken Thain (Lead), John Ebenger, Ryan Ebenger, Jonathan Epp, Nathan Moller, Jonathan Perry, Michelle Pettit-Mee, Guilherme Ramos

Systems Designers: Georg Zoeller (Lead), Andrew Gauthier, Scott Horner, Emmanuel Lusinchi, David Sitar, Peter Thomas

Technical Designers: Yaron Jakobs (Lead), Mark Barazuol, Rick Burton, Craig Graff, Kaelin Lavallee, Antony Lynch, Grant Mackay, Cori May, David Sims, Gary Ian Stewart, Josh Stiksma, Keith Warner

Writers: David Gaider (Lead), Ferret Baudoin, Sheryl Chee, Daniel Erickson, Jennifer Brandes Hepler, Mary Kirby, Luke Kristjanson, Jay Turner

Technical Editors: Chris Corfe, Dan Lazin, Karin Weekes

Additional Design: Rob Bartel, Eric Fagnan, James Henley, Jason Hill, Bret Hoffman, Chris L'Etoile, Ian Morrison, Austin Peckenpaugh, Kris Schoneberg, Patrick Weekes, Dan Whiteside, Wolfram Wikeley

Senior Design Consultant: Kevin Martens

Directors of Design: Kevin Barrett, Matt Robinson

Production

Producers: Derek French, Vanessa Kade, Kevin Loh, Kyle Scott

Project Managers: Alain Baxter, Karen Clark, Erin Devarennes, Adriana Lopez

Additional Production:

Scott Greig (Former Project Director), Trent Oster (Eclipse Engine Initial Direction), Darcy Pajak

Director of Production: Duane Webb

Programming

Engine Architects: Derek Beland, Paul Roffel

Audio Programmer: Marek Galach

Graphics Programmers: Dave Hill (Lead), Patrick Chan, Jason Knipe, Andreas Papatathanasis, Daniel Torres, Peter Woytjuk, Keith Yerec

Localization Programmers: Chris Christou, Kristopher Tan

Programmers: Jacques Lebrun (Game Engine Lead), Noel Borstad, Owen Borstad, Gavin Burt, John Fedorkiw, Hesky Fisher, Dmitry Gapesin, Andrew Gardner, Brenon Holmes, Jose Iltzky, Yuri Leontiev, Gabriel Moreno Fortuny, Nicolas NgManSun, Eric Paquette, Paul Schultz, Chris Michael Smith, Henry Smith, Craig Welburn, Graham Whildal

Tools Programmers: Tim Smith (Architect), Ted Chen, James Goldman, Bo Liang, Scott Meadows, Curtis Onuczko, James Redford, Sydney Tang, Jon Thompson, Mika Uusnaki

Initial Technology: Mark Brockington (Lead), Brook Bakay, Jonathan Baldwin, John Bible, Bob Boyd, Alden Chew, Neil Flynn, Mark Jaskiewicz, Mark Kennedy, Zach Kuznia, Sophia Lamar, Christopher Mihalick, Don Moar, Zousar Shaker, Janice Thoms

Intern Programmers: Jonathan Cooper, Bogdan Corciova, Jonathan Ferland, Cody Watts

Technical Editor: Bryan Derksen

Additional Programming: Andy Desplenter, Blake Grant, Pat LaBine, Jocelyn Legault, Nathan Sturtevant, Steven Hand

Director of Programming: Aaryn Flynn

Quality Assurance

Analysts: Zac Beaudoin (Technical Lead), Jason Leong (Online Lead), Homan Sanaie (External Lead), Guillaume Bourbonniere, Chris Buzon, Robert Girardin, Dieter Goetzinger, Jack Landen, Scott Langevin, Joshua Langley, Arone "QA Monkey" Le Bray, Michael Liaw, Ryan Loe, Ivan Mulkeen, Vanessa Prinsen, Mark Ramsden, Allan Smith, Bruce Venne, Mike Wellman, Stanley Woo

QA Programmers: Sam Johnson, Alex Lucas, Dave Schaefer, Jay Zhou

Term Testers: Dave Berkes, Melissa Costanzo, Chad De Wolfe, John Epler, Dale Furutani, Will Kuhn, Catherine Lundgren, Carlo Lynch, Pieter Parker, Richard Poulin, Colin Steedman, Jennifer Stefan, Thomas Trachimowich, Tory Turner, Devon Wetheral, Sarah Weymouth, Nathan Willis, Dann Wurster

Additional QA: Reid Buckmaster, Steven Deleeuw, Mitchell Fujino, Cynthia Howell, Martin Lunde, David Lynch, Russell Moore, Mark Spuniarsky, Iain Stevens-Guille, Daniel Trotter

Director of QA: Ron Clement

Marketing

Director of Marketing: Ric Williams

Senior Brand Manager: David S. Silverman

Assistant Brand Manager: Randall Bishop

Public Relations: Matt Atwood, Erik Einsiedel

Web: Isa Amistad, Jeff Marvin, Derek Larke, Nadia Phillipchuk, Jeff Rousell, Jesse Van Herk

Community: "Evil" Chris Priestly, Jay Watamaniuk

Art: Colin Walmsley

Video: Neel Upadhye

Additional Marketing: Michael Avery, Jon Bailey

Operations

Director of Operations: Darryl Horne

Directors of Business Development: Richard Iwaniuk, Robert Kallir

Executive Assistants: Teresa Meester, Lanna Mess

Finance

Director of Finance: Kevin Gunderman

Finance / Payroll: Calvin Chan, Todd Derechey, Sharon Pate, Treena Rees

Human Resources

Director of Human Resources: Mark Kluchyk

Human Resources: Celia Arévalo, Theresa Baxter, Holly Bierbaum, Tammy Johnson, Leanne Korotash

Additional HR: Derek Sidebottom (Former Director of Human Resources)

Information Systems, Facilities, and Administration

Director of Information Systems, Facilities, and Administration: Vince Waldon

Administration: Keri Clark (Office Manager), Crystal Ens, Deb Gardner, Leah Hollands, Nils Kuhnert, Jo Marie Langkow, Jeanne-Marie Owens

Application Support: Lee Evanochko (Manager), Julian Karst, Robert McKenna

Desktop Support: Chris Zeschuk (Manager), Dave McGruther, Brett Tollefsen

Facilities: Mike Patterson (Manager), Kelly Wambold

Infrastructure: Craig Miller (Manager), Sam Decker, Wayne Mah

Special Thanks

Diarmid Clarke, Cookie Everman, Corey Gaspar, Chris Hepler, Drew Karpyshyn, Christina Norman, Mike Spalding, Mike Trotter, Mac Walters, Preston Watamaniuk, Edward Bolme, David Gross, Stephen Hand, Gorman Ho, Mike Sass, Don Yakielashch, Elevation Partners, Pandemic Studios, the rest of the BioWare teams in Edmonton, Austin, and Montreal, and the rest of the team at EA/L and EA. Thanks to all our families for your support!

Studio Leadership, BioWare

General Manager and Chief Executive Officer: Ray Muzyka
VP, Development Operations: Greg Zeschuk

BIOWARE CONSOLE TEAM

Core Design

Alain Baxter, Zac Beaudoin, Daniel Fedor, Ross Gardner, Jeff Holzhauser, Pat LaBine, Homan Sanaie

Senior Leadership

Producer: Jeff Holzhauser

Project Manager: Alain Baxter

Lead Artists: Daniel Fedor, Ben McGrath

Lead Technical Designers: Yaron Jakobs, Keith Warner

Lead Programmers: Pat LaBine, Ross Gardner

Quality Assurance Leads: Zac Beaudoin, Homan Sanaie

Art and Animation

GUI Artists: Warren Heise (Lead), Tyler Lee

Lead Animator: Clove Roy

Cinematic Animator: Nathan Zufelt

In-Game Animator: Cody Paulson

Technical Animators: Charles Looker, Kevin Ng

Character Artists: Shane Hawco (Lead), Leroy Chen, Jae Keum, Francis Lacuna, Ken Finlayson

Level Artists: Sheila Nash, Lee Scheinbeim, Ian Stubbington

Technical Artists: Brian Chung, Suhwan Pak

Visual Effects Artists: Alim Chaarani (Lead), Jacky Xuan

Additional Art: Dean Andersen (Art Director), Matthew Goldman (Art Director)

Audio and Localization

Audio Lead: Jeremie Voillot

Localization Producer: Jenny McKeearney

Assistant Localization Producer: Jason Barlow

Design

Lead Designer: Mike Laidlaw

Technical Designers: Kaelin Lavalee, Antony Lynch

Technical Editors: Chris Corfe, Dan Lazin

Production

Executive Producer: Mark Darrah

Online Producer: Fernando Melo

Programming

Engine Architect: Derek Beland

Graphics / Platform Programmers: Devin Doucette, Dave Hill, Andreas Papathanasis, Matt Peters, Paul Roffel, Graham Whildal, Keith Yerex

Programmers: Jacques Lebrun (User Interface Lead), Mark Brockington, John Fedorkiw, Sebastian Hanlon, Jose Iltzky, Paul Schultz, Chris Michael Smith, Henry Smith

Localization Programmer: Chris Christou

Tools Programmers: Owen Borstad, Curtis Onuczko, Scott Meadows, Sydney Tang, Mika Uusnaki, Jon Thompson

Additional Programming: Gavin Burt, Patrick Chan, David Cope (EA Tech), Jonathan Ferland, Dmitry Gapeskin, James Goldman, Bo Liang, Nicholas NgManSun, Eric Paquette, Georg Zoeller

Quality Assurance

Analysts: Jason Leong (Online Lead), Andrew Gauthier, Robert Girardin, Dieter Goetzinger, Jack Lamden, Joshua Langley, Mark Ramsden, Allan Smith, Bruce Venne, Mike Wellman

QA Programmers: Alex Lucas, Edward Basset, Sam Johnson, Dave Schaefer, Chester Szeto, Jay Zhou

Term Testers: Dave Berkes, Michael Boyce, Reid Buckmaster, Alberto Cea, David Clifford, Chad De Wolfe, Dale Furutani, Andrew Gray, Alan Hildebrandt, Patrick Irwin, Will Kuhn, Michael Lang, James Leung, Geoff Loken, Catherine Lundgren, David Lynch, Russell Moore, Cody Ouimet, Corey Owens, Lee Panas, Joshua Peterman, Richard Poulin, Owen Quance, Steven Rideout, Allan Schumacher, Mark Shpuniarsky, Colin Steedman, James Trachimowich, Thomas Trachimowich, Tory Turner, Matthew Villeneuve, Devon Wetheral, Sarah Weymouth, Nathan Willis

Additional QA: Nathan Frederick (Quality Assurance Lead)

EDGE OF REALITY CONSOLE TEAM

Senior Leadership

Producer: Hang Lau

Lead Designer: Dominic Craig

Lead Programmer: Jacob Meakin

Lead Artist: Billy Sullivan

Art

Character Artists: Xavier Blackwell, Joe Lee, Jared Rudiak

GUI Artists: Steven Mullins, Nancy Olender

Level Artists: Angel Arca, Stacy Dopson, Rick Kohler, Abram Syphrett, Michael Taylor

Technical Artists: Thomas Coles, Paul Haskins, Chris Stone

Audio

Audio Designer: W. Scott Snyder (Lead), Alex Keller, Homero Sanchez, Heather Sowards

Design

Technical Designer: Walter Badgett

Production

Assistant Producers: Nathan McClellan, Cullen Scarborough

Programming

Programmers: Dave Barrett (Engine Lead), Sky Schulz (Network Lead), Michael Atchison, Nimrod Barak, Michael Bosley, Arturo Caballero, Anthony DeLiberio, Craig Galley, Clark James, Mark Lewis, Justin Marcus, Johnny Salazar, Daniel Silver, Clark Smith, Daniel Talaber, Ike Ton, D. Michael Traub, Chris Wingle

Quality Assurance

Analysts: Alex Thurman (Lead), Adnan Chatriwala, Jonathan Conine, Robert Freeling, Jeannette Lee, James LeGerros, Gene Moore, Ryan Ploetz, Thomas Portman, Matthew Smith, Jason Staten, Aaron Walsh, Laurie Wicker

Studio Management and Administration

President: Binu Philip

CEO / Technical Director: Rob Cohen

Vice-President: Mike Panoff

Creative Director: Mark Nau

Art Director: Wan Woo "Ewan" Lee

Director of Development: Gabe Jones

Human Resources Manager: Kerrisa Maddocks
IT / Network Admin: Jordan Greenstreet, Michael Thai

Special Thanks

Johnny Chu, Neil Davis, Devin Dixon, Lonnie Fink, Marcus Hays, Brittany Henry, Steve Lewis, Janice Panoff, Rachel Ryan, Shawn Wingle, and thanks to all our families for your support!

CAST

Alistair: Steve Valentine

Duncan: Peter Renaday

Flemeth: Kate Mulgrew

Ari Howe: Tim Curry

Leliana: Corinne Kempa

Loghain: Simon Templeman

Morrigan: Claudia Black

Oghren: Steve Blum

Sten: Mark Hildreth

Wynne: Susan Boyd Joyce

Zevran: Jon Curry

Additional Voices: Patrick J. Adams, Jocelyn Ahlf, Matthew Ashforde, Desmond Askew, Robin Atkin Downes, April Banigan, Steve Barr, Michael Beattie, Rob Beckwith, Nicola Bertram, Betsy Beutler, Connor Bewick, Shannon Blanchet, Brian Bloom, Nick Boulton, Peter Bramhill, Wendy Braun, Kimberly Brooks, Julianne Buescher, Simon Chadwick, Cam Clarke, Josh Cohen, Jim Connor, Stephane Cornicard, Belinda Cornish, Elliot Cowan, Chris Cox, Kat Cressida, Jim Cummings, Tim Dadabo, Atiya Iman Dattoo, Josh Dean, Barry Dennen, Shaun Dingwall, Chris Edgerley, Paul Eiding, Jeannie Elias, Greg Ellis, Gideon Emery, Corri English, Keith Ferguson, Emma Fielding, Patrick Fraley, Victoria Gay, Brian George, Jesse Gervais, Jamie Glover, Ezra Godden, Michael Gough, Beth Graham, H. Richard Greene, Michael Gregory, Zach Hanks, Jeff Haslam, Cornelia Hayes O'Herlihy, Mark Healy, Theo Herdman, Dan Hildebrand, Victoria Hoffman, Julian Holloway, Adam Howden, Peter Jessop, Joel Johnstone, Eve Karpf, Seana Kofoed, Richard Laing, Ken Lally, Lex Lang, Adam Leadbeater, Wendee Lee, Natasha Little, David Lodge, Yuri Lowenthal, Erica Luttrell, Kim Mai Guest, Stefan Marks, Drew Massey, Fay Masterson, Erin Matthews, Mark Evan McCintock, Richard McGonagle, Graham McTavish, Mark Meer, Roland Meseck, Deborah Moore, Nolan North, Liam O'Brien, Michael Parsons, Louisa Patikas, Vyvan Pham, Tara Platt, Alix Wilton Regan, David Rintoul, Philip Anthony Rodriguez, Mark Rolston, John Rubinow, Tim Russ, Robin Sachs, Salli Saffioti, Eliza Jane Schneider, Dwight Schultz, Carolyn Seymour, Lloyd Sherr, Deo Simcox, Mika Simmons, Jason Singer, David Sobolov, Kath Soucie, Valerie Spencer, Gillon Stephenson, Robbie Stevens, April Stewart, Cree Summer, Keith Szarabajka, Fred Tatasciore, Courtenay Taylor, Hellea Taylor, Kirk Thornton, Jemma Tonken, John Ulyatt, Karl Wahlgren, Audrey Wasilewski, Tim Watson, Douglas Weston, Colette Whitaker, James Wilson, Helen Wilson, Wally Wingert, Jo Wyatt, Matt Yang King

EA

Corporate Leadership

Chief Executive Officer: John Riccitiello

President, Global Publishing and Chief Operating

Officer: John Schappert

Executive Vice-President and Chief Financial Officer: Eric Brown

Executive Vice-President, Business and Legal Affairs: Joel Linzner

Executive Vice-President, Human Resources: Gabrielle Toledano

Senior Vice-President and Chief Accounting Officer: Ken Barker

Senior Vice-President, General Counsel, and Corporate Secretary: Stephen G. Bene

Games Label Leadership

President: Frank Gibeau

Chief Financial Officer: Mike Williams

Chief Operations Officer: Bryan Neider

Chief Technical Officer: David O'Connor

Vice-President, Human Resources: Steve Cadigan

Vice-President, Marketing: Mike Quigley

RPG/MMO Group

Senior Vice-President and Group General Manager: Ray Muzyka

Vice-President and Group Creative Officer: Greg Zeschuk

Vice-President and Group Marketing Vice-President: Patrick Buechner

Localization

Production: Victoria Rose (International Project Manager), Pablo Dopico, Claudia Serafim, Sibylle Steinau

Engineering: Rubén Martín Rico (Project Lead), Danilo José Guerrero Rodríguez (Technical Lead), Alberto Abad, Santiago Albert, Pedro Alfageme, Luis Javier Lopez Arredondo, Mario Bergantiños, Cesar Puerta, Juan Serrano

Coordination: Nathalie Bonin, Marcel Elsner, Silvia Favia, Marta Julke, Alfonsina Mossello, Mária Nagy, Ana Ramirez Boix, Ana Esther Rodriguez, Jan Staniček, Anna Tomala, Leonid Vekshin

Quality Assurance: Fausto Ceccarelli (Project Manager), Esther Jansen (Project Manager), Elena Anuffrieva, Eugene Bogdanov, Robert Börski, Paolo Catozzella, Philippe Charel, Lucas Costas, Tomasz Dobosz, Blazej Domański, Timothée Even, Elena Filippova, Federico Franzoni, Tatiana Gerasina, Paolo Giovenco, Romain Guilloteau, Christian Isopp, Zbigniew Kajak, Michał Kukawski, Alexandre Lelandais, Iñigo Luzuriaga, Gilles Mathiaut, Akos Mikola, Marco Nicolino, Jiří Noska, Maciej Ogiński, Jekaterina Panova, Steffen Paul, Šárka Pechočáková, Pavel Permin, Roman Pillard, Harald Raschen, Florian Ross, Jose Santamarina, Laurent Siddi, Miroslaw Staniak, Svítlana Sukhova, Bertold Virág, Marius Wolstzajn

EA Madrid Mastering Lab: John Brunton (Manager), Rubén Del Pozo Moreno, Jakub Jilek, Tomas Pedroño, Anthony Jones

Marketing and Publishing

Senior Director of Brand Integration: Rod Swanson

Senior Director of Public Relations: Tammy Schachter

Ad Manager: David Sullivan

Creative Services: Corey Higgins (Vice-President), John Burns, Nathan Carrico, Daniel Davis, Joe Kaiser, Audrey Genet, Julie-Anne LaRochele

EDP Group: Michael Herst (Director), Derek Andersen

Senior Buyer and Planner: Ann Marie Ramirez

Global Publishing: Maria Sayans (EU Marketing Director), Walter Grinberg (International Marketing Manager), Peter Aleshkin, Astasios Anestis, Ralph Anheier, Thiago Appella, Craig Auld, Ferry Brands, Christian Brueckner, ALEXandre Caldeira, Tommy Chen, Hazy Cho, Kenneth Chow, Juraj Chrappa, Farid Dilmaghani, Patrick Eilfeld, Christoph Ehrenzeller, Jaroslav Fallus, Ian Freitas, Adrian Fromion, Kevin Flynn, Michael Galli, Jemma Glancy, Jonathan Goddard, William Graham, Jonathan Harris, Paul Hellmrich, Dulcie Ho, Ellen Hsu, Zen Huan, Tomasz Jarzebowski, Cameron Jenkins, Orsolya Kasza, Alexander Lui, George Mamkos, Nikolaos Maniatis, Daniel Montes, Christopher Ng, Justin Olivares, Sophie Orlando, Mathieu Pastéran, Dominique Poldervaart, Sven Schmidt, Inna Shevchenko, Daniele Siciliano, Andrea Smidova, Ralph Spinks, Wojciech Szajdak, Veerle Taeye, Diana Tan, Tomasz Tinc, Mario Valle, Vanessa Van Maurik, Tony Watkins, Valentina Zlobina, Krzysztof Zych

Additional Marketing: EA Demand Planning team, EA Sales and Retail Marketing team, EALA Mastering Lab, EARS Mastering Lab

Online

Leadership: Rob Bastian, Darko Bojanic, Javier Cubero, Joel Tablante, Lily Weiss

Producers: Lars Smith, Shawn Stafford

Programmers: George Arriola, Ryan Butterfoss, Chris Carrier, Corey Johnson, Omar Moussawel, Yugesh Naicker, Vikash Shah, Philip Smith, Mark Waller

QA Analysts: Melissa Jamili, Abigail Poquez-Cervantes, Minsu Sohn

Quality Assurance

Lead Tester: Eric Neugebauer

Compatibility Testers: William Brewer, Tim Duong, Kevin Quan, Chris Sevigny, James Wang, Irwin Wong-Sing

Core Testers: Kristopher Buller, Eric Hanna, Cleveland Miettunen, Brian Penner, Curtis Roy, Donovan Styre, Katherine Teel, Ashton Tower

Playtesters: Raman Bassi, Kenny Chan, My Diep, Dung Hoang, Andrew Hulme, Albert Hutson, Alvin Jiang, Jeffrey Kamo, Cord Krohn, Thomas Kuo, Bruce Lin, Chris McHugh, Joshil Patel, Stephen Potts, Greg Priebe, Robert Ricketts, Laura Savage, Robyn Sinclair, Richard Skinner, Corey Tam, Gary Yau

EXTERNAL PARTNERS

Art and Animation

Additional Animation: Big Sandwich Games, Iron Claw

Additional Art: Liquid Development, LLC, Shadows in Darkness, Hermitworks Entertainment Corporation

Motion Capture: Giant Studios, EA Worldwide Motion Capture Studio

Audio and Localization

Dialogue Editing / Post-Production: Wave Generation

Geopolitical Evaluation: Englobe, Inc.

Original Score: Inon Zur

Translation: Albion (Poland), András Gáspár - Fontoló Stúdió Ltd. (Hungary), Robert Böck (Germany), CEET Ltd. (Czech Republic), Emanuele Scichilone - Synthesis International S.r.l. (Italy), ExeQuo (France), ITI Ltd. (Russia), Synthesis Iberia (Spain), Florian Vanino (Germany)

Voice-Over Direction (Los Angeles): Chris Borders, Ginny McSwain

Voice-Over Production Services: (London) Productions, Inc.

Voice-Over Recording: Side UK (Tokyo), Technicolor Interactive Services (Burbank), Wolf Willow Sound (Edmonton), ArcTV Ltd. (Russia), ExeQuo (France), Start International Polska (Poland), toneworx GmbH (Germany)

Marketing

Advertising Agency: Drafftcb

EXTERNAL CONSOLE PARTNERS

EA Canada

Testers: Tommy Hsu (Lead), David Eriksen (Senior), William Brewer, Jesse Bryant, Kristopher Buller, Raphael Chan, Kristin Czarny, Matthew Grant, Eric Hanna, Darren Joe, Byron Leung, Jordan Mews, Jamie Milman, Gustavo Morales, Marco Pasqua, Jeffrey Rosmer, Curtis Roy, Nathan Sereda, Ashton Tower

EA Madrid

Testers: Carmen Álvarez García, Pierre Attali, Giulio Cioncoloni, Phillipe Charel, Lorenzo Confalonieri, Rafał Czapski, Michał Kukawski, Vasilij Mercalovs, Steffen Paul, Laetitia Roques, Ekaterina Samolyak, Oliver Schönhöbet, Sigfrido Zazpe, Aleksandra Zrebić

Tiburón

Testers: Rob Diaz, Daniel Foote, Rachel Jollette

Globant

Testers: Anibal Berisso (Lead), Axel Rolón (Assistant Lead), Tomás Romero Borzi, Mauro Fernandez, Mariano Gigante, Andrés Lobato, Alvaro Mañanes, Andrés Marquis, Andrés Miglio, Pablo Moabro, Paola Parra, Eduardo da Ponte, Jerónimo Shannon, Alejandro Spampinato, Ramiro Zapata

"Dragon Age: Origins (Opening Theme)"

Music by Inon Zur

Lyrics by Inon Zur and Aubrey Ashburn

Vocals by Aubrey Ashburn

"Leliana's Song"

Music by Inon Zur

Vocals by Aubrey Ashburn

"Love Song"

Music by Inon Zur

Lyrics and vocals by Aubrey Ashburn

"I Am the One" and "I Am the Lonely One"

Music by Aubrey Ashburn and Inon Zur

Lyrics by Aubrey Ashburn

"This Is War"

Performed by 30 Seconds to Mars

Written by Jared Leto

Published by Apocraphex Music / Universal Music - Z Tunes LLC (ASCAP)

Recording courtesy of Virgin Records America, LLC under license from EMI Film & Television Music